

ISO-PLUG INSULATION FIXINGS

For fastening lightweight fixtures on insulated facades eliminating thermal bridging, applications with screw diameter 4-5mm and all length from 40mm.

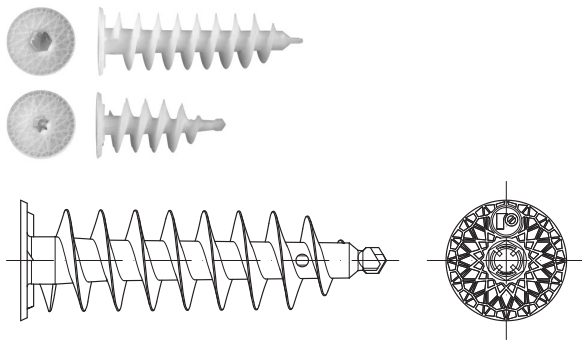

Product information

Features and benefits

- No thermal bridging
- Can be installed with commercial drill/drive tool.
- The geometry of the ISO-PLUG allows for a simple installation in thin layers of plaster, without the need for pre-drilling, thus saving a stage of installation
- Fixtures are fixed with a wide range of screws, diameter 4-5mm and length from 40mm
- Unique construction of screw thread section provides support for wide variety of diameters, without limitation of screws' length.
- Unique self-drilling point allow precise installation through any type of façade plaster, preventing from breaking its surface
- Ribs on the internal surface of plate provide locking in surface during driving screws in and out and even surface of plug with substrate after fixing
- Proper shape of TX/HEX socket provides stabilization during the process of driving in by providing necessary grip for the bit

Applications

- Façade construction (ETICS)
- Attachments to insulation
- Lightweight recycled panels
- Electrical fittings
- Refrigeration and climate control

Base materials

Approved for use in:

- Polystyrene (EPS) Boards
- Mineral Wool Boards

Installation guide

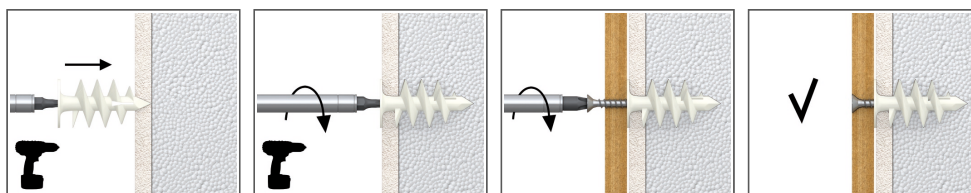

1. Drive R-ISO-PLUG into the insulation material (manually, or with an electric screwdriver) until installation depth reached.
2. Insert screw of required diameter into plug through fixture and tighten.
3. Fixtures are fixed with a proper screw diameter. R-ISO-PLUG-50 with diameter of the screw between 4-5mm and R-ISO-PLUG-80 with screw diameter 6-7mm.

Product commercial data

Size	Product Code	Quantity [pcs]			Weight [kg]			Bar Codes
		Box	Outer	Pallet	Box	Outer	Pallet	