

T-LUZ QUICK LINK WITHOUT SCREW LOCK

Quick repair link for attachment and connecting parts of the chain



Product information

Features and benefits

- Designed for lightweight chain repair and chain attachments
- Made of low carbon steel
- Hot galvanized for enhanced corrosion resistance
- Quick and convenient way to connect segments of the chain

Applications

- Connecting of chains and ropes
- Setting up anchors and fixing grips
- Chain repair and chain attachments

Product information

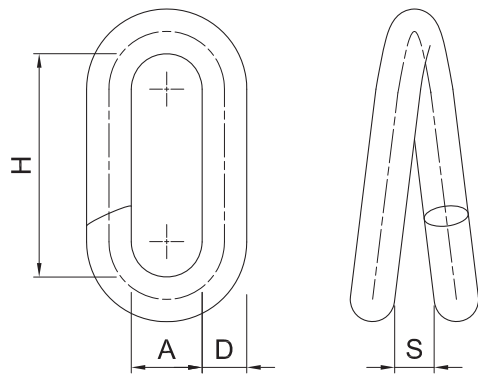

Product Code	Dimensions			
	A	D	H	S
	[mm]	[mm]	[mm]	[mm]
T-LUZ-035	7	4	20	11
T-LUZ-050	13	5	26	11
T-LUZ-060	14	5.6	32	20

Product commercial data

Product Code	Dimensions				Quantity [pcs]			Weight [kg]			Bar Codes
	A [mm]	D [mm]	H [mm]	S [mm]	Box	Outer	Pallet	Box	Outer	Pallet	
T-LUZ-035	7	4	20	11	100	1200	28800	0.62	7.4	208.6	5906675132143
T-LUZ-050	13	5	26	11	50	900	21600	0.81	14.5	377.8	5906675132150
T-LUZ-060	14	5.6	32	20	50	900	21600	1.33	23.9	602.4	5906675132167