

KT Zink-plated low weight mechanical sleeve anchor

Low weight mechanical sleeve anchor



Product information

Features and benefits

- Low weight mechanical sleeve anchor
- Easy and fast installation
- Suitable for temporary fixings
- Product approved AT option 7

Applications

- Radiators
- Satellite dishes
- Signs
- Shutter
- Garage doors

Base materials

Approved for use in:

- Non-cracked Concrete
- Solid Brick

Installation guide

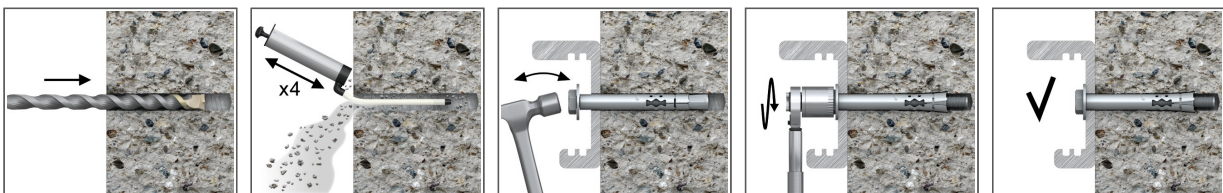

1. Drill a hole of required diameter and depth
2. Remove debris and thoroughly clean hole with brush and pump
3. Insert Rawlock through the fixture into the hole
4. Tighten to the recommended torque

Product information

Size	Product Code	Anchor			Fixture	
		Thread diameter	Length	Head size	Max. thickness	Hole diameter
		d	L	K	t _{fix}	d _f
		[mm]	[mm]	[mm]	[mm]	[mm]
M6	KT-08040	6	46	10	2	8
	KT-08065	6	71	10	15	8
	KT-08085	6	92	10	45	8
M8	KT-10040	8	49	13	3	10
	KT-10050	8	58	13	3	10
	KT-10080	8	83	13	30	10
	KT-10100	8	102	13	50	10
M10	KT-10125	8	133	13	75	10
	KT-12060	10	69	15	3	12
	KT-12075	10	83	15	15	12
	KT-12100	10	107	15	40	12
M12	KT-12130	10	138	15	70	12
	KT-16110	12	118	18	50	16
M12	KT-16150	12	155	18	90	16
	KT-20110	16	115	24	40	20
M16	KT-20150	16	150	24	80	20

Installation data

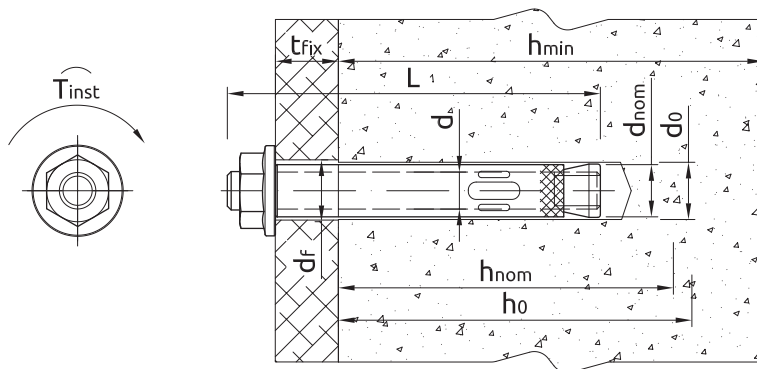

Size			M6	M8	M10	M12	M16
Thread diameter	d	[mm]	6	8	10	12	16
Hole diameter in substrate	d ₀	[mm]	8	10	12	16	20
Installation torque	T _{inst}	[Nm]	12	35	70	120	200
Min. hole depth in substrate	h ₀	[mm]	40	50	60	60	70
Min. installation depth	h _{nom}	[mm]	35	40	50	55	60
Min. substrate thickness	h _{min}	[mm]	70	80	100	110	120
Min. spacing	s _{min}	[mm]	105	120	150	165	180
Min. edge distance	c _{min}	[mm]	55	60	75	85	90

Mechanical properties

Size			M6	M8	M10	M12	M16
Nominal ultimate tensile strength - tension	f _{uk}	[N/mm ²]	500	500	500	500	500
Nominal yield strength - tension	f _{yk}	[N/mm ²]	400	400	400	400	400
Cross sectional area - tension	A _s	[mm ²]	20.1	36.6	58	84.3	157
Elastic section modulus	W _{el}	[mm ³]	21.21	50.27	98.17	169.56	402.12
Characteristic bending resistance	M ⁰ _{Rk,s}	[Nm]	12.72	30.16	58.9	101.79	241.27
Design bending resistance	M	[Nm]	10.18	24.13	47.12	81.43	193.02

Basic performance data

Size		M6	M8	M10	M12	M16
Effective embedment depth h_{ef}	[mm]	35.00	40.00	50.00	55.00	60.00
CHARACTERISTIC LOAD						
TENSION LOAD N_{Rk}	[kN]	6.00	6.00	19.00	27.00	31.00
SHEAR LOAD V_{Rk}	[kN]	6.00	6.00	19.00	27.00	31.00
DESIGN LOAD						
TENSION LOAD N_{Rd}	[kN]	2.85	2.85	9.04	12.85	14.76
SHEAR LOAD V_{Rd}	[kN]	4.80	4.80	15.20	21.60	24.80

Design performance data

Size		M6	M8	M10	M12	M16
Effective embedment depth	h_{ef} [mm]	35.00	40.00	50.00	55.00	60.00
TENSION LOAD						
NON-CRACKED CONCRETE C20/25						
Characteristic load	N_{Rk} [kN]	6.00	6.00	19.00	27.00	31.00
Installation safety factor	γ_{inst}	1.40	1.40	1.40	1.40	1.40
Increasing factors for $N_{Rd,p}$ - C30/37	ψ_c	1.22	1.22	1.22	1.22	1.22
Increasing factors for $N_{Rd,p}$ - C40/50	ψ_c	1.41	1.41	1.41	1.41	1.41
Increasing factors for $N_{Rd,p}$ - C50/60	ψ_c	1.55	1.55	1.55	1.55	1.55
SOLID BRICK 15MPA						
Characteristic load	N_{Rk} [kN]	5.00	5.50	-	-	-
Installation safety factor	γ_{inst}	1.66	1.66	-	-	-
SHEAR LOAD						
NON-CRACKED CONCRETE C20/25						
Characteristic load	V_{Rk} [kN]	6.00	6.00	19.00	27.00	31.00
Installation safety factor	γ_{inst}	1.25	1.25	1.25	1.25	1.25
SOLID CLAY BRICK 15MPA						
Characteristic load	V_{Rk} [kN]	5.00	5.50	-	-	-
SOLID BRICK 15MPA						
Installation safety factor	γ_{inst}	1.25	1.25	-	-	-

Product commercial data

Product Code	Anchor	Quantity [pcs]			Weight [kg]			Bar Codes
	Length [mm]	Box	Outer	Pallet	Box	Outer	Pallet	
KT-08040	46	100	100	19200	1.55	1.55	326.8	5906675020129
KT-08065	71	100	100	19200	2.3	2.3	447.6	5906675020228
KT-08085	92	100	100	19200	2.9	2.9	588.0	5906675020327
KT-10040	49	100	100	19200	3.0	3.0	598.3	5906675021126
KT-10050	58	50	50	9600	1.64	1.64	344.1	5906675021225
KT-10080	83	50	50	9600	2.2	2.2	449.5	5906675021324
KT-10100	102	50	50	9600	2.6	2.6	531.5	5906675021423
KT-10125	133	50	50	8000	3.4	3.4	565.8	5906675021522
KT-12060	69	50	50	8000	2.9	2.9	491.3	5906675022123
KT-12075	83	50	50	8000	3.4	3.4	570.3	5906675022222
KT-12100	107	25	25	4800	2.2	2.2	444.9	5906675022321
KT-12130	138	25	25	4800	2.7	2.7	548.0	5906675022420
KT-16110	118	20	20	3200	3.0	3.0	514.2	5906675023120
KT-16150	155	20	20	3200	3.8	3.8	636.4	5906675023229
KT-20110	115	10	10	1920	2.7	2.7	555.9	5906675024127
KT-20150	150	10	10	1440	3.7	3.7	566.8	5906675024226