

# FIX NYLON EXPANSION PLUG WITH SCREW

Easy-to-install plug giving exceptional performance in solid base materials



## Product information

### Features and benefits

- Anti-rotation fins prevent spinning during tightening of the screw.
- Engineered grip feature for extra holding power.
- Two-way expansion mechanism provides a strong anchorage in solid base materials.
- Small edge distances achievable.

### Applications

- Pictures
- Lighting
- Skirting / Dado railing
- Shelves
- Trunking
- Cable trays
- Electrical fittings
- Letterboxes

### Base materials

**Approved for use in:**

- Concrete
- Solid Brick
- Solid Sand-lime Brick
- Aerated Concrete Block

## Installation guide

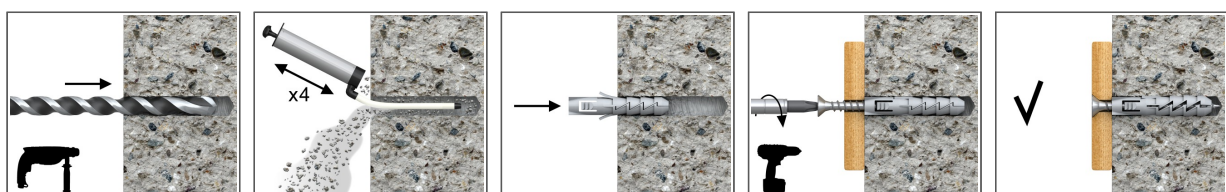

1. Drill a hole of required diameter.
2. Insert FIX plug into hole and tap home.
3. Insert screw of required diameter into plug through fixture and tighten.

## Product information

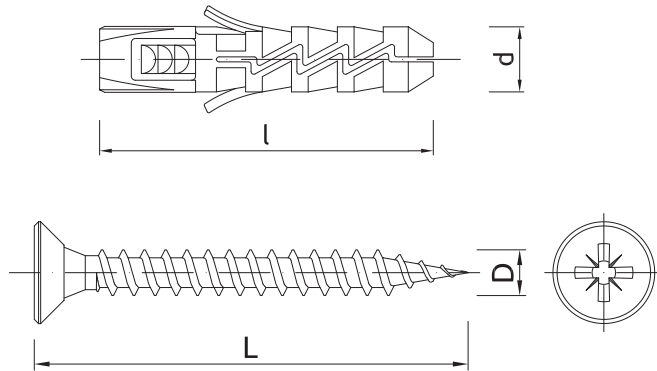

Product dimensions

Size	Product Code	Plug		Screw		Fixture		Screw	
		Diameter	Length	Diameter	Length	Max. thickness	Hole diameter	Diameter	Length
		d	l	D	L	t <sub>fix</sub>	d <sub>i</sub>	d <sub>1</sub>	L1
[mm]									
Ø5	FIX-N-05+	5	25	3,5	30	5	4	-	-
Ø8	FIX-N-08+450	8	40	-	-	10	5	4.5	50

## Installation data

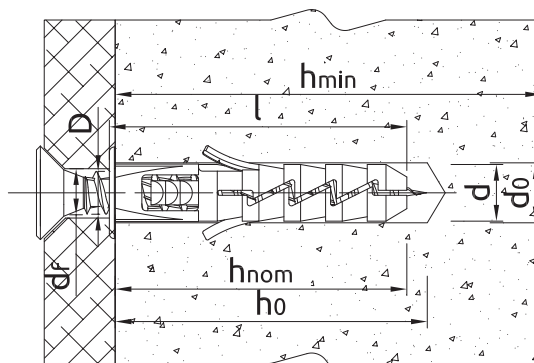

Installation data

Size			Ø5	Ø6	Ø8	Ø10
Fixing diameter	d	[mm]	5	6	8	10
Hole diameter in substrate	d <sub>0</sub>	[mm]	5	6	8	10
Min. hole depth in substrate	h <sub>0</sub>	[mm]	35	40	50	60
Min. installation depth	h <sub>nom</sub>	[mm]	25	30	40	50
Min. substrate thickness	h <sub>min</sub>	[mm]	80	80	80	80
Min. spacing	s <sub>min</sub>	[mm]	50	60	80	100
Min. edge distance	c <sub>min</sub>	[mm]	50	60	80	100

## Basic performance data

Performance data for single fixing without influence of edge distance and spacing

Substrate	Concrete C20/25 - C50/60	Solid clay brick min 20MPa (eg Mz20/2.0)	Sand-lime solid brick	Aerated concrete 600 Mark V	Hollow lightweight concrete block	
<b>CHARACTERISTIC LOAD</b>						
<b>TENSION LOAD N<sub>Rk</sub></b>						
Ø5, Embedment depth 25mm	[kN]	0.10	0.10	0.10	0.15	0.20
Ø6, Embedment depth 30mm	[kN]	0.15	0.15	0.30	0.40	0.40
Ø8, Embedment depth 40mm	[kN]	0.50	0.50	1.20	0.75	-
Ø10, Embedment depth 50mm	[kN]	0.40	0.40	0.60	0.90	-

## Basic performance data

Substrate		Concrete C20/25 - C50/60	Solid clay brick min 20MPa (eg Mz20/2.0)	Sand-lime solid brick	Aerated concrete 600 Mark V	Hollow lightweight concrete block
<b>SHEAR LOAD <math>V_{Rk}</math></b>						
Ø5, Embedment depth 25mm	[kN]	0.10	0.10	0.10	0.15	0.20
Ø6, Embedment depth 30mm	[kN]	0.15	0.15	0.30	0.40	0.40
Ø8, Embedment depth 40mm	[kN]	0.50	0.50	1.20	0.75	-
Ø10, Embedment depth 50mm	[kN]	0.40	0.40	0.60	0.90	-
<b>DESIGN LOAD</b>						
<b>TENSION LOAD <math>N_{Rd}</math></b>						
Ø5, Embedment depth 25mm	[kN]	0.06	0.04	0.04	0.08	0.08
Ø6, Embedment depth 30mm	[kN]	0.08	0.06	0.12	0.20	0.16
Ø8, Embedment depth 40mm	[kN]	0.28	0.20	0.48	0.38	-
Ø10, Embedment depth 50mm	[kN]	0.22	0.16	0.24	0.45	-
<b>SHEAR LOAD <math>V_{Rd}</math></b>						
Ø5, Embedment depth 25mm	[kN]	0.08	0.08	0.08	0.12	0.16
Ø6, Embedment depth 30mm	[kN]	0.12	0.12	0.24	0.32	0.32
Ø8, Embedment depth 40mm	[kN]	0.40	0.40	0.96	0.60	-
Ø10, Embedment depth 50mm	[kN]	0.32	0.32	0.48	0.72	-
<b>RECOMMENDED LOAD</b>						
<b>TENSION LOAD <math>N_{rec}</math></b>						
Ø5, Embedment depth 25mm	[kN]	0.04	0.03	0.03	0.05	0.06
Ø6, Embedment depth 30mm	[kN]	0.06	0.04	0.09	0.14	0.11
Ø8, Embedment depth 40mm	[kN]	0.20	0.14	0.34	0.27	-
Ø10, Embedment depth 50mm	[kN]	0.16	0.11	0.17	0.32	-
<b>SHEAR LOAD <math>V_{rec}</math></b>						
Ø5, Embedment depth 25mm	[kN]	0.06	0.06	0.06	0.09	0.11
Ø6, Embedment depth 30mm	[kN]	0.09	0.09	0.17	0.23	23.00
Ø8, Embedment depth 40mm	[kN]	0.29	0.29	0.69	0.43	-
Ø10, Embedment depth 50mm	[kN]	0.23	0.23	0.34	0.51	-

## Product commercial data

Product Code	Plug	Screw		Quantity [pcs]			Weight [kg]			Bar Codes	
	Diameter [mm]	Length [mm]	Diameter [mm]	Length [mm]	Box	Outer	Pallet	Box	Outer		Pallet
FIX-N-05+	5	30			200	6400	153600	0.40	12.8	336.9	5906675290997
FIX-N-08+450	8		4.5	50	200	2400	57600	0.21	2.5	90.5	5906675091358
R-FIX-N-06+440					200	4800	115200	0.55	13.2	346.8	5906675252735
R-FIX-N-08+550					200	2400	57600	1.03	12.4	327.8	5906675252742
R-FIX-N-10+660					100	1200	28800	0.94	11.3	300.7	5906675252759