

KD Frame fixing with long expansion zone - hex head

Frame fixing with long expansion zone



Product information

Features and benefits

- Frame fixing with countersunk plug and hexagonal head allows stable mounting of hard materials (e.g. steel)
- Durable, high quality PA6 grade nylon plug for extended fixing life
- Tough nylon sleeve prevents frame distortion during tightening
- Zig-zag design ensures enhanced expansion
- Special design with anti-rotation lugs
- No marking out required - drill straight through the frame

Applications

- Door and window frames
- Wall cabinets
- Shelves
- Balustrading & handrails

Base materials

Approved for use in:

- Hollow Brick
- Aerated Concrete Block

Installation guide

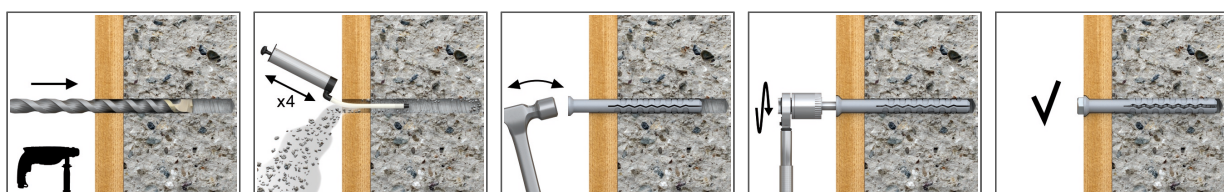

1. Drill a hole of required diameter and depth
2. Lightly tap the plug through the fixture into hole with a hammer, until fixing depth is reached
3. Tighten the screw

Product information

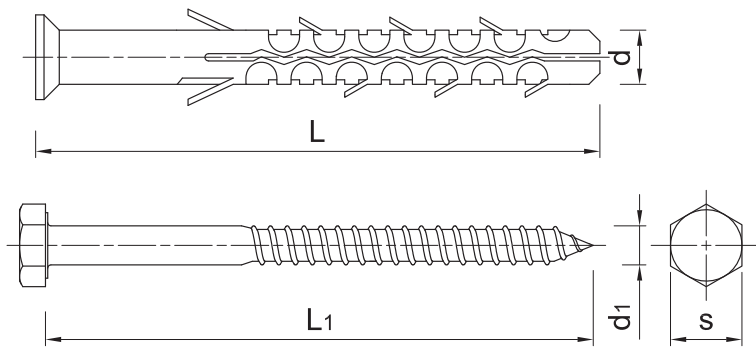

Size	Product Code	Plug		Screw		Fixture	
		Diameter	Length	Diameter	Length	Max. thickness	Hole diameter
		d	l	d _i	L1	t _{fix}	d _i
[mm]							
Ø10	KD-10080	10	80	6.8	90	20	11
	KD-10100	10	100	6.8	110	40	11
	KD-10120	10	120	6.8	130	60	11
	KD-10140	10	140	6.8	150	80	11
	KD-10160	10	160	6.8	170	100	11
	KD-10200	10	200	6.8	210	140	11
	KD-10240	10	240	6.8	250	180	11
Ø16	KD-16140	16	140	11.7	150	40	17
	KD-16160	16	160	11.7	170	60	17
	KD-16200	16	200	11.7	210	100	17
	KD-16240	16	240	11.7	250	140	17

Installation data

Size			Ø10	Ø16
Hole diameter in substrate	d ₀	[mm]	10	16
Min. hole depth in substrate	h ₀	[mm]	70	110
Min. installation depth	h _{nom}	[mm]	60	100
Min. substrate thickness	h _{min}	[mm]	80	120
Min. spacing	s _{min}	[mm]	30	55
Min. edge distance	c _{min}	[mm]	30	55
Fixing diameter	d	[mm]	10	16

Basic performance data

Performance data for single fixing without influence of edge distance and spacing

Substrate		Aerated concrete 500	Hollow brick 3.5MPa	Long expansion zone perforated brick (eg. porotherm) 400
MEAN ULTIMATE LOAD F_{Ru,m}				
Ø10	[kN]	2.63	1.82	1.56
Ø16	[kN]	3.54	2.50	1.71
CHARACTERISTIC LOAD F_{Rk}				
Ø10	[kN]	1.41	1.44	1.04
Ø16	[kN]	2.78	2.10	1.31
DESIGN LOAD F_{Rd}				
Ø10	[kN]	0.71	0.58	0.42
Ø16	[kN]	1.39	0.84	0.52
RECOMMENDED LOAD F_{Rrec}				
Ø10	[kN]	0.50	0.40	0.30
Ø16	[kN]	1.00	0.60	0.40

Product commercial data

Product Code	Plug	Screw		Quantity [pcs]			Weight [kg]			Bar Codes
	Diameter [mm]	Length [mm]	Box	Outer	Pallet	Box	Outer	Pallet		
KD-10080	10	6.8	90	50	600	14400	1.30	15.6	405.0	5906675104126
KD-10100	10	6.8	110	25	400	9600	0.84	13.4	351.4	5906675104225
KD-10120	10	6.8	130	25	400	9600	0.97	15.5	400.9	5906675104324
KD-10140	10	6.8	150	25	300	7200	1.12	13.4	351.7	5906675104423
KD-10160	10	6.8	170	25	300	7200	1.26	15.1	393.2	5906675104522
KD-10200	10	6.8	210	25	200	4800	1.60	12.8	336.8	5906675104621
KD-10240	10	6.8	250	25	200	4800	1.90	15.2	395.6	5906675104027
KD-16140	16	11.7	150	20	20	2300	2.8	2.8	351.8	5906675111124
KD-16160	16	11.7	170	20	20	2300	3.1	3.1	383.9	5906675111223
KD-16200	16	11.7	210	20	20	2300	3.7	3.7	453.4	5906675111322
KD-16240	16	11.7	250	20	20	600	4.4	4.4	161.3	5906675111421