

## QUICK LINK WITH SCREW LOCK

Quick link with screw lock for connecting of chains and ropes



### Product information

#### Features and benefits

- Quick and convenient way to connect segments of the chain
- Screw lock for secure connection
- Hot galvanized for enhanced corrosion resistance
- Screw closure allows the reuse of the link
- Manufactured in accordance with DIN 5299

#### Applications

- Connecting of chains and ropes
- Setting up anchors and fixing grips
- Chain repair and chain attachments

## Product information

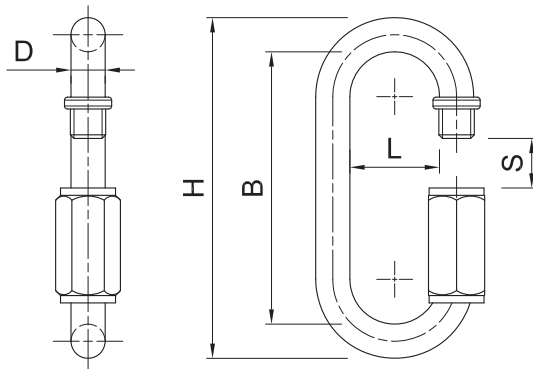

Product Code	Dimensions				
	D	H	L	B	S
	[mm]	[mm]	[mm]	[mm]	[mm]
T-LU-04	4	39.5	11	32	5.5
T-LU-06	6	57	14	45	7.5
T-LU-08	8	74	17	58	10

## Basic performance data

Product Code	Load resistance	
	Maximum	
	[kg]	
T-LU-04	90.00	
T-LU-06	200.00	
T-LU-08	350.00	

## Product commercial data

Product Code	Dimensions					Quantity [pcs]			Weight [kg]			Bar Codes
	D [mm]	H [mm]	L [mm]	B [mm]	S [mm]	Box	Outer	Pallet	Box	Outer	Pallet	
T-LU-04	4	39.5	11	32	5.5	50	1200	1200	0.60	14.3	44.3	5906675965970
T-LU-06	6	57	14	45	7.5	50	900	21600	1.00	18.0	462.0	5906675966076
T-LU-08	8	74	17	58	10	25	450	10800	1.79	32.2	803.3	5906675966175