

Stud connectors DIN 6334

Designed for connecting two male-threaded components. Finished in zinc electroplated coating for enhanced corrosion resistance.

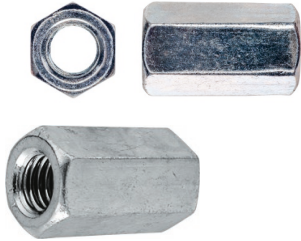

Product information

Features and benefits

- Quick and easy installation
- Removable - screw may be removed and reinserted
- Threaded rod made of carbon steel class 8.8 is suitable for outdoor use and in damp conditions

Applications

- Steel construction
- Balustrading
- For fastening of threaded rods or bolts
- Heavy machinery
- Radiators
- Railings
- Rebar
- Shelves
- Signs
- Steel columns
- Steelwork
- Supports
- Wood boards

Product information

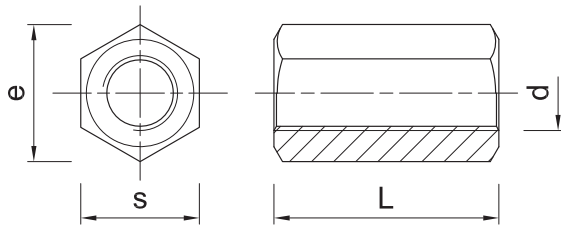

Product Code	Dimensions			
	d	L	s	D
	[mm]	[mm]	[mm]	[mm]
I-6334-05-ZN	M5	15	8	8.79
I-6334-06-ZN	M6	18	10	11.05
I-6334-08-ZN	M8	24	13	15
I-6334-10-ZN	M10	30	16	19.6
I-6334-12-ZN	M12	36	19	21.9
I-6334-16-ZN	M16	48	24	27.7
I-6334-20-ZN	M20	60	30	34.6
I-6334-24-ZN	M24	72	36	40.05

Product commercial data

Product Code	Dimensions				Quantity [pcs]			Weight [kg]			Bar Codes
	d [mm]	L [mm]	s [mm]	D [mm]	Box	Outer	Pallet	Box	Outer	Pallet	
I-6334-05-ZN	M5	15	8	8.79	250	4000	180000	1.06	17.0	795.0	5906675031224
I-6334-06-ZN	M6	18	10	11.05	250	3000	90000	2.0	24.0	750.0	5906675271767
I-6334-08-ZN	M8	24	13	15	250		19200	4.5		375.6	5906675271774
I-6334-10-ZN	M10	30	16	19.6	125	500	22500	4.0	16.0	750.0	5906675031521
I-6334-12-ZN	M12	36	19	21.9	75	300	13500	4.5	18.0	840.0	5906675031620
I-6334-16-ZN	M16	48	24	27.7	150	150	5400	17.4	17.4	655.1	5906675031828
I-6334-20-ZN	M20	60	30	34.6	20	40	3600	4.0	8.0	750.0	5906675031927
I-6334-24-ZN	M24	72	36	40.05	10	10	660	4.0	4.0	291.6	5906675031026