

D-ZU Universal angle brackets

Universal angle bracket for connection of wood construction elements



Approvals and Reports

- ETA-12/0523



Product information

Features and benefits

- Connection of wooden construction elements
- Steel sheet thickness: 2.0 mm
- Zinc electroplated for enhanced corrosion resistance
- Anti-corrosion coating thickness min. 8µm

Applications

- Wooden constructions
- Wooden fences
- Window ledge supports
- Shelving reinforcement
- Counter brackets
- Pergolas, bowers, sheds
- Versatile utility reinforcements

Base materials

Approved for use in:

- Timber
- Chipboard

Also suitable for use in:

- Chipboard
- Plywood

Installation guide

1. Choose the right size of wood connector
2. Set the connector in required place and position
3. Fasten the connector using anchor nails or adequate screws

Product information

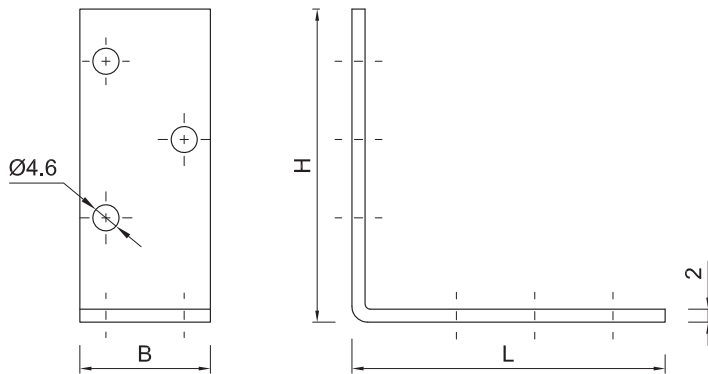

Product Code	Connector dimensions			Number of holes
	Dimensions			
	B	H	L	Ø4.6
	[mm]			
D-ZU-3325	25	30	30	2 + 2
D-ZU-4425	25	40	40	2 + 2
D-ZU-5525	25	50	50	3 + 3
D-ZU-6625	25	60	60	3 + 3
D-ZU-5530	30	50	50	3 + 3
D-ZU-5730	30	50	70	3 + 4

Basic performance data

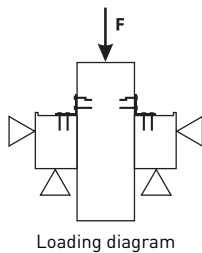

Product Code	Load resistance		
	Characteristic	Design	Recommended
	[kN]	[kN]	[kN]
D-ZU-3325	3.08	1.00	0.70
D-ZU-4425	3.08	1.00	0.70
D-ZU-5525	3.08	1.00	0.70
D-ZU-6625	3.08	1.00	0.70
D-ZU-5530	3.08	1.00	0.70
D-ZU-5730	3.08	1.00	0.70

Product commercial data

Product Code	Connector dimensions			Quantity [pcs]			Weight [kg]			Bar Codes
	Dimensions [mm]			Box	Outer	Pallet	Box	Outer	Pallet	
D-ZU-3325 ¹⁾	25	30	30	300	300	32400	6.5	6.5	729.8	5906675483320
D-ZU-4425 ¹⁾	25	40	40	230	230	12420	7.0	7.0	405.1	5906675483429
D-ZU-5525 ¹⁾	25	50	50	190	190	10260	6.8	6.8	395.3	5906675483528
D-ZU-6625 ¹⁾	25	60	60	150	150	8100	6.8	6.8	396.9	5906675483627
D-ZU-5530 ¹⁾	30	50	50	160	160	8640	7.1	7.1	414.5	5906675484129
D-ZU-5730 ¹⁾	30	50	70	130	130	7020	7.0	7.0	408.4	5906675484228

1) ETA-12/0523