

# R-FTC Drywall collated screws for wood

Coarse thread screws for fixing plasterboards to wooden framing

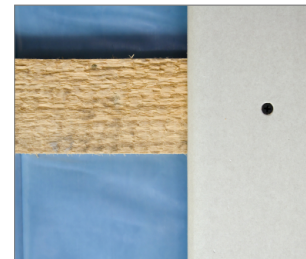
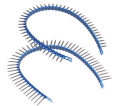

## Approvals and Reports

PN-EN 14566 + A1: 2012

DoP-EN14566

Reaction to fire: A1

Flexural strength: pass

CE  
10

## Product information

### Features and benefits

- Top-quality material and dimensional accuracy of the collating strip for improved firmness and stability of screw feeding into the screwdriver ensuring minimised screw jamming or skipping risk
- Optimised screw tip geometry - excellent drilling capability
- No pre-drilling required
- Low-carbon steel with black phosphate finish for increased durability
- Bugle head with PH2 drive designed to finish flush with plasterboard

### Applications

- Fastening plasterboard walls to wooden framework

### Base materials

**Approved for use in:**

- Wood

## Installation guide

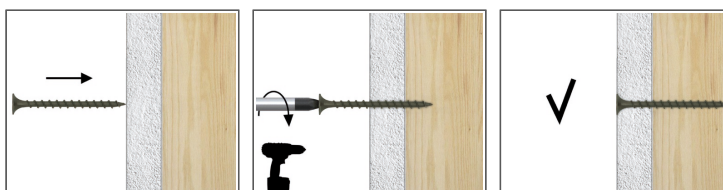

1. Drive the screw straight until the head is flush
2. Screws with countersunk head allow flush connection

## Product information

Size	Product Code	Screw		Fixture
		Diameter	Length	Max. thickness
		d	L	t <sub>fix</sub>
		[mm]	[mm]	[mm]
Ø3.5	R-FTC-3535	3.5	35	18
	R-FTC-3538	3.5	38	21
	R-FTC-3545	3.5	45	28
	R-FTC-3555	3.5	55	38
	R-FTC-3525	3.5	25	18

## Installation data

Size	Ø3.5		
Substrate	Timber		
Min. installation depth	h <sub>nom</sub>	[mm]	14
Min. substrate thickness	h <sub>min</sub>	[mm]	28
Min. spacing	s <sub>min</sub>	[mm]	30
Min. edge distance	c <sub>min</sub>	[mm]	30

## Basic performance data

Performance data for single screw without influence of edge distance and spacing

Size	Ø3.5		
Substrate	Steel		
Substrate thickness h <sub>min</sub>	[mm]	0.5	
<b>CHARACTERISTIC LOAD F<sub>Rk</sub></b>			
FT F <sub>Rk</sub>	-	0.55	
<b>DESIGN LOAD F<sub>Rd</sub></b>			
FT F <sub>Rd</sub>	-	0.29	
<b>RECOMMENDED LOAD F<sub>REC</sub></b>			
FT F <sub>rec</sub>	-	0.21	

## Product commercial data

Product Code	Screw	Quantity [pcs]			Weight [kg]			Bar Codes
	Length [mm]	Box	Outer	Pallet	Box	Outer	Pallet	
R-FTC-3535	35	1000.0	10000.0	1000000.0	1.91	19.1	4614.0	5906675486611
R-FTC-3538	38	1000.0	10000.0	1000000.0	2.1	20.9	3366.0	5906675486628
R-FTC-3545	45	1000.0	10000.0	1000000.0	2.3	23.4	3769.2	5906675486635
R-FTC-3555	55	1000.0	10000.0	1000000.0	2.8	27.6	4452.4	5906675486642
R-FTC-3525	25	1000.0	12000.0	180000.0	2.0	23.8	386.4	5906675192925