

D-MI Equal length angle bracket - light

Equal length angle bracket for connecting of wood construction elements



Approvals and Reports

- ETA-12/0523



Product information

Features and benefits

- Connection of wooden construction elements
- Steel sheet thickness: 2.0 mm
- Zinc electroplated for enhanced corrosion resistance
- Anti-corrosion coating thickness min. 8µm

Applications

- Wooden constructions
- Wooden fences
- Window ledge supports
- Shelving reinforcement
- Counter brackets
- Pergolas, bowers, sheds
- Versatile utility reinforcements

Base materials

Approved for use in:

- Timber

Also suitable for use in:

- Chipboard
- Plywood

Installation guide

1. Choose the right size of wood connector
2. Set the connector in required place and position
3. Fasten the connector using anchor nails or adequate screws

Product information

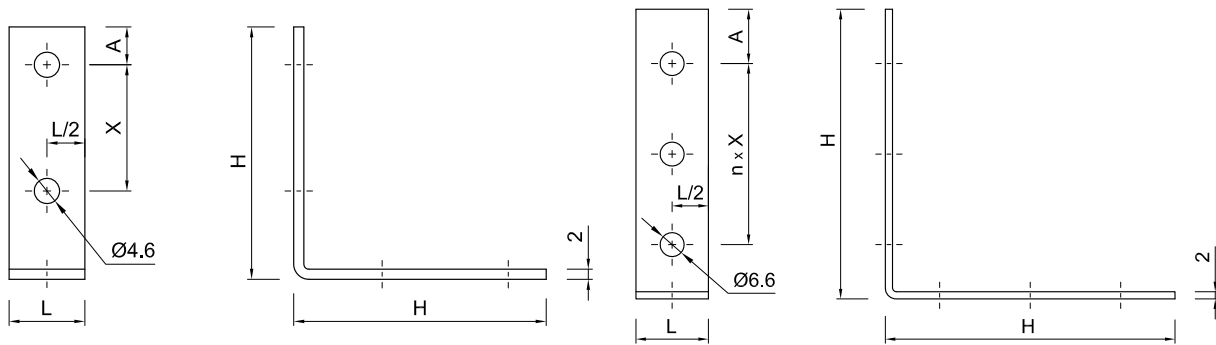

Product Code	Connector dimensions			Number of holes
	Dimensions		n x X	
	H	L		Ø6.6
[mm]				
D-MI-2215	25	15	1 x 10	2 x 2
D-MI-3315	30	15	1 x 15	2 x 2
D-MI-4415	40	15	1 x 20	2 x 2
D-MI-5515	50	15	1 x 25	2 x 2
D-MI-6620	60	20	1 x 35	2 x 2
D-MI-8820	80	20	2 x 25	2 x 3
D-MI-1120	100	20	2 x 35	2 x 3

Basic performance data

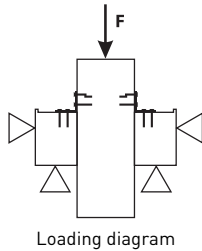

Product Code	Load resistance		
	Characteristic	Design	Recommended
	[kN]	[kN]	[kN]
D-MI-2215	2.01	0.65	0.50
D-MI-3315	2.01	0.65	0.50
D-MI-4415	2.01	0.65	0.50
D-MI-5515	2.01	0.65	0.50
D-MI-6620	2.01	0.65	0.50
D-MI-8820	4.06	1.30	0.90
D-MI-1120	4.06	1.30	0.90

Product commercial data

Product Code	Connector dimensions		Quantity [pcs]			Weight [kg]			Bar Codes
	Dimensions [mm]		Box	Outer	Pallet	Box	Outer	Pallet	
D-MI-2215 ¹⁾	25	15	600	600	32400	7.3	7.3	422.0	5906675472126
D-MI-3315 ¹⁾	30	15	100	100	48000	1.24	1.24	625.2	5906675472225
D-MI-4415 ¹⁾	40	15	350	350	110250	2.0	2.0	647.4	5906675472324
D-MI-5515 ¹⁾	50	15	250	250	60000	2.5	2.5	618.0	5906675472423
D-MI-6620 ¹⁾	60	20	200	200	42000	7.2	7.2	1542.0	5906675472522
D-MI-8820 ¹⁾	80	20	150	150	8100	7.3	7.3	423.7	5906675472720
D-MI-1120 ¹⁾	100	20	120	120	18000	7.3	7.3	1128.0	5906675472928

1) ETA-12/0523