

TM Internally threaded brass anchor

Brass anchor for medium loads suitable for all screws and studs with a metric thread

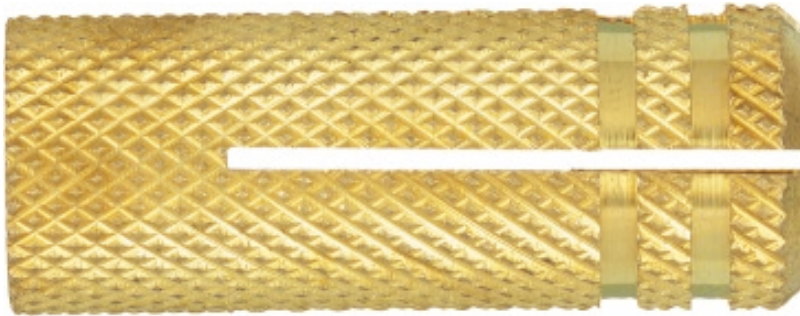

Product information

Features and benefits

- Fixing allows the attached item to be reusable
- Special surface structure prevents from rotating in the hole
- Low installation depth reduces amount of drilling
- The internal thread allows for the use of standard metric screws or threaded rods, and for surface flush removal and reuse of the fixing point. This provides great flexibility.
- Suitable for pre-positioned and push-through installation.

Applications

- Handrails
- Shelves
- Fixing light shelving, brackets and hooks
- Curtain rails
- Bathroom fittings
- Control boxes

Base materials

Suitable for use in

- Concrete

Installation guide

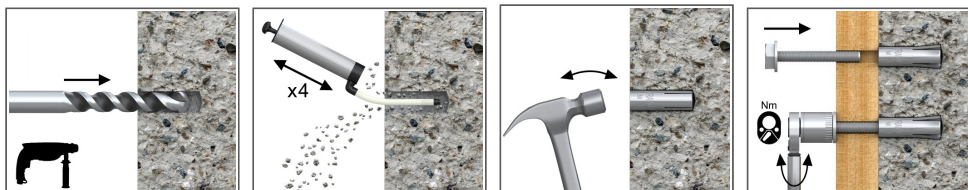

1. Drill a hole of required diameter and depth
2. Remove debris and thoroughly clean hole with brush and pump
3. Insert wedge anchor, slotted end first
4. Insert bolt or stud through fixture and tighten to the recommended torque

Product information

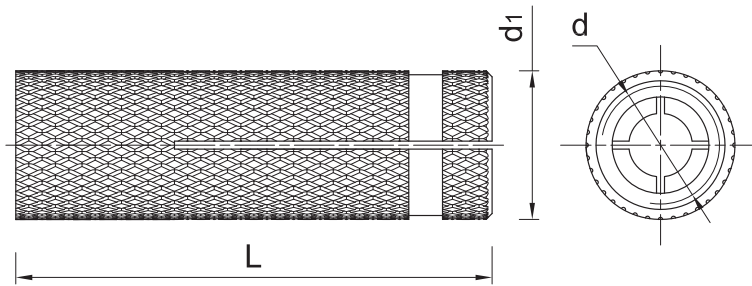

Product Code	Anchor		
	Thread diameter	External diameter	Length
	d	d _{nom}	L
	[mm]		
TM-05	5	7	20
TM-06	6	8	23
TM-08	8	10	28
TM-10	10	12	32
TM-12	12	15	38
TM-16	16	20	43

Installation data

Size			M5	M6	M8	M10	M12	M16
Thread diameter	d	[mm]	5	6	8	10	12	16
Hole diameter in fixture	d _f	[mm]	6	7	9	11	13	18
Hole diameter in substrate	d ₀	[mm]	7	8	10	12	15	20
Min. hole depth in substrate	h ₀	[mm]	22	25	30	34	40	45
Min. installation depth	h _{nom}	[mm]	20	23	28	32	38	43
Min. substrate thickness	h _{min}	[mm]	80	100	100	100	100	100

Product commercial data

Product Code	Anchor	Quantity [pcs]			Weight [kg]			Bar Codes
	Length [mm]	Box	Outer	Pallet	Box	Outer	Pallet	
TM-05	20	100	3200	128000	0.34	10.7	458.8	5906675032023
TM-06	23	100	1600	64000	0.44	7.0	308.4	5906675032122
TM-08	28	100	800	32000	0.68	5.4	246.3	5906675032221
TM-10	32	100	800	32000	1.11	8.9	386.7	5906675032320
TM-12	38	50	400	16000	1.13	9.1	392.9	5906675032429
TM-16	43	25	200	8000	1.12	9.0	388.7	5906675032627