

# R-BRUSH Manual Cleaning System

Brush accessory for cleaning out holes prior to anchor installation



## Product information

### Features and benefits

- Ideal for cleaning dust from drilled holes prior to applying bonded anchors or installing mechanical anchors
- Hole cleaning is necessary for correct loads
- Suitable for variable anchor embedment depths up to 2,5 m.
- Suitable for repetitive and frequent use.

### Applications

- Drilling holes in concrete, brick and stone
- Rebar missed-outs
- Rebar
- Post-installed rebar connections
- Formwork installation
- Securing formwork
- Shear dowel connections
- Foundation wall connections
- Renovation and modernization of bridges, buildings.

### Base materials

- Approved for use in:**
- Concrete C12/15-C50/60

## Installation guide

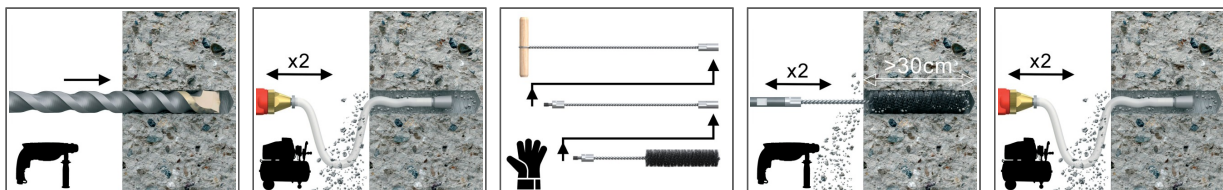

1. Drill hole to the required diameter and depth for stud size being used.
2. Before inserting anchor, clean inside of hole by compressed air starting from the drill hole bottom. Blow the hole at least twice by compressed air at minimum 6 bar.
3. Choose extensions and brushes to the selected depth and diameter of the hole, then combine them into one set.
4. Clean the hole twice with a prepared brush set.
5. Clean the hole again with compressed air.

## Product information

Product Code	Length	Diameter	Drill diameter	Stud size	Rebar diameter
	L	D			d <sub>s</sub>
	[mm]	[mm]			[mm]
R-BRUSH-EXT-LH	360	-	-	-	-
R-BRUSH-EXT-LT	360	-	-	-	-
R-BRUSH-12-TC	200	12	10	M8	-
R-BRUSH-14-TC	200	14	12	M10	8
R-BRUSH-16-TC	200	16	14	M12	10
R-BRUSH-18-TC	200	18	16	-	12
R-BRUSH-20-TC	200	20	18	M16	14
R-BRUSH-22-TC	200	22	20	-	16
R-BRUSH-27-TC	200	27	25	M20	20
R-BRUSH-32-TC	200	32	30	M24	25
R-BRUSH-37-TC	200	37	35	M30	28
R-BRUSH-42-TC	200	42	40	-	32
R-BRUSH-52-TC	200	52	50	-	40

## Product commercial data

Product Code	Length [mm]	Drill diameter [mm]	Stud size	Quantity [pcs]			Weight [kg]			Bar Codes
				Box	Outer	Pallet	Box	Outer	Pallet	
R-BRUSH-EXT-LH	360			1	1	750	0.08	0.08	90.0	5906675432779
R-BRUSH-EXT-LT	360			1	1	1200	0.08	0.08	124.8	5906675432762
R-BRUSH-12-TC	200	10	M8	1	1	500	0.05	0.05	55.0	5906675432656
R-BRUSH-14-TC	200	12	M10	1	1	4125	0.05	0.05	236.3	5906675432663
R-BRUSH-16-TC	200	14	M12	1	1	4125	0.06	0.06	277.5	5906675432670
R-BRUSH-18-TC	200	16		1	1	3750	0.06	0.06	255.0	5906675432687
R-BRUSH-20-TC	200	18	M16	1	1	500	0.07	0.07	65.0	5906675432694
R-BRUSH-22-TC	200	20		1	1	2625	0.07	0.07	213.8	5906675432700
R-BRUSH-27-TC	200	25	M20	1	1	2625	0.10	0.10	292.5	5906675432717
R-BRUSH-32-TC	200	30	M24	1	1	500	0.11	0.11	85.0	5906675432724
R-BRUSH-37-TC	200	35	M30	1	1	1600	0.13	0.13	238.0	5906675432731
R-BRUSH-42-TC	200	40		1	1	960	0.13	0.13	152.9	5906675432748
R-BRUSH-52-TC	200	50		1	1	960	0.15	0.15	174.0	5906675432755