

## RPP-FIX-GRAPH Polyurethane Adhesive

Polyurethane adhesive with applicator gun, designed for bonding AQUA EPS and EPS boards for the insulation of facades and foundations.

### Product information



### Applications

- For bonding expanded graphite polystyrene boards (EPS) on facade installations
- For bonding hydrophobic boards (AQUA EPS) on building foundations
- For bonding expanded polystyrene insulation
- For bonding and insulation of wall panels, corrugated sheets, roof tiles, etc.
- Suitable for fixing styrofoam boards in thermal insulation of buildings in the systems ETICS with mechanical fixings
- Filling gaps in the thermal insulation of buildings
- For fixing various types of insulation boards
- The polyurethane adhesive shows excellent adhesion to concrete, ceramic and wooden substrates as well as to PVC and all kinds of polystyrene, plasters and substrates with a bituminous coating, tar paper and asphalt insulating masses



### Features and benefits

- Fixing possible just two hours after application.
- One product for thermal insulation of facades (EPS) and foundations (AQUA EPS).
- Highly efficient - coverage of about 8m<sup>2</sup> facades and approx 12m<sup>2</sup> foundations.
- Possible application at +5 °C which significantly prolongs the construction season
- Portable - no requirement for access to water and electricity.
- High strength characteristics and excellent adhesion to common construction materials

### Base materials

Approved for use in:

Also suitable for use in:

### Installation guide

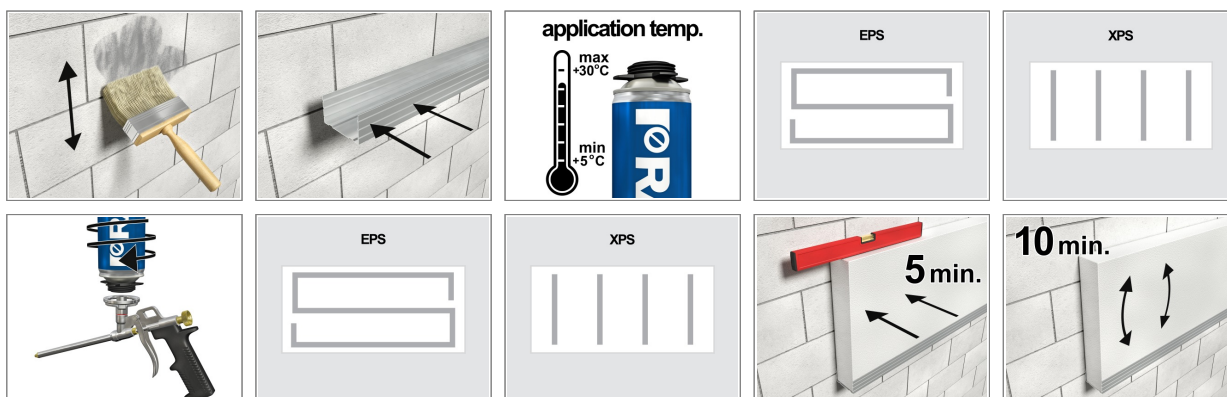

1. Wear protective gloves. Ensure surfaces are free from dust, dirt, lime or grease. If the wall surface is dirty it must be primed.
2. Before adhering polystyrene board, starter track must be installed. Shake can vigorously for 30 seconds to mix properly components.
3. Optimal can temperature is +20°C. Application temperature from -5°C up to +30°C. Screw gun onto the can. Hold can upside-down during application.
4. For adhesion of foamed polystyrene facade insulation, apply a braid of Styrofix (approx. 3 cm wide) around the perimeter of polystyrene boards (approx. 2 cm from the edge), with an additional strip across the centre of the board.
5. For adhesion of hydrophobic boards (AQUA EPS) on foundations, apply Styrofix in 4 vertical braids (approx. 3 cm wide) maintaining equal spacing of 20-30 cm between the strips. Ensure 3 cm clearance from the edge of the board (for boards wider than 100 cm, more braids should be applied).
6. Allow max. 5 minutes after application of Styrofix before mounting insulation to the facade or foundation. After mounting, adjust board to the desired position. Board adjustment is only possible for up to 10 minutes after adhesion. In the case of detachment from the surface apply again Styrofix.
7. At lintels and in the corners, support the boards (approx. 10-15 min) until the bond cures. After 2 h the boards should be polished with an abrasive paper and additionally fixed with special mechanical connectors. Fill gaps between boards using Styrofix. When fully cured, the excess of adhesive should be removed mechanically (eg. using a knife).
8. After removing the applicator gun from the can, wipe down the nozzle and gun (internal and external surfaces) using a cleaner.

## Technical Data

Parameter		Value	Methods
Application temperature	[°C]	+5 ÷ +30	
Can temperature	[°C]	20	
Adhesive coverage	[m <sup>2</sup> ]	max. 12 (for XPS); max. 8 (for BSO); Efficiency depends on air humidity and temperature.	
Colour	-	grey	
Correction time	[min]	4	
Skin formation time	[min]	5 - 12	25°C, RH 50%
Pretreatment time	[min]	40 - 60	20°C, RH 90%
Working time	[h]	2	
Complete hardening time	[h]	24	
Compressive strength	[kPa]	≥ 40	PN-EN 826:1998
Dry density	[kg/m <sup>3</sup> ]	13÷17	
Dimensional stability	[%]	1 - 2	40°C, RH 95%, 24 hrs
Preparations solubility	-	Acetone, before hardening	Cleaner RPC-0500
Fire resistance class	-	B3	DIN 4102
Adhesion to the substrate coated with bitumen	[kPa]	≥ 150	
Tensile strength	-	≥ 100	PN-EN 1607:1999
Thermal resistance (upon hardening)	[°C]	-50 ÷ +90	
Water absorption after 24h	[kg/m <sup>2</sup> ]	1	PN-EN 1609:1999
Thermal conductivity	[W/mK]	0,036	
Volume	[ml]	750	

Parameter		Value
Shelf life	[month]	12
Storage conditions	-	upright position in an originally closed container the storage temperature: from +5°C to +35°C (room temperature is recommended) dry, cool and well-ventilated place away from direct sunlight and other sources of heat and ignition storing the product in conditions other than recommended may shorten the life time even by 3 months

### Product commercial data

Product Code	Colour	Volume [ml]	Quantity [pcs]			Weight [kg]			Bar Codes
			Box	Outer	Pallet	Box	Outer	Pallet	
RPP-FIX-GRAPH	grey	750	12	12	672	11.0	11.0	644.5	5906675513942