

TFIX-8ST-ECO Universal Facade Fixing for countersunk installation in insulation board

Thermal insulation combination screw fixing that can be countersunk together with the integrated perforator for installation with insulation cap

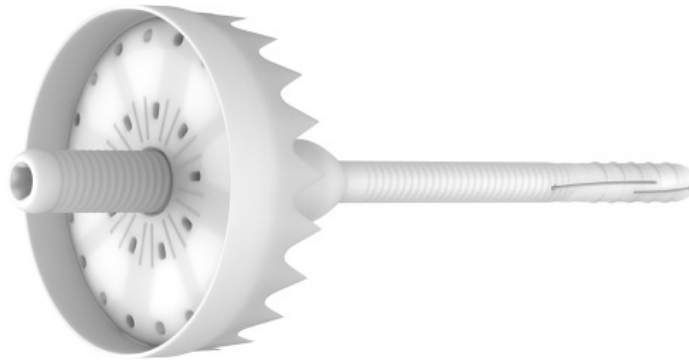

Product information

Features and benefits

- Accurate countersunk setting - TFIX-DEVICE automatically sets the fixing flush with the insulation layer.
- Countersunk installation (with post-installed insulation cap) reduces heat transmission and results in a homogenous insulation surface.
- The long plastic overmoulding on the TFIX-8S screw minimises thermal bridging (value 0.002W/K), contributing to energy-saving benefits
- Unique sleeve compression zone for precision installations.
- Simple countersunk installation in all substrates (A,B,C,D,E).
- The shortest embedment depth at the maximum strength parameters

Applications

- External Thermal Insulation Composite Systems (ETICS)
- Polystyrene (EPS) boards
- Mineral wool (MW) boards
- Polyurethane (PU) boards

Base materials

Approved for use in:

- Concrete C12/15-C50/60 (Use category A)
- Solid Brick (Use category B)
- Solid Sand-lime Brick (Use category B)
- Hollow Brick (Use category C)
- Hollow Sand-lime Brick (Use category C)
- Vertically-perforated clay block (Use category C)
- Lightweight Concrete Block (Use category C)
- Hollow Lightweight Concrete Block (Use category D)
- Reinforced components of lightweight aggregate concrete (Use category D)
- Aerated Concrete Block (Use category E)

Installation guide

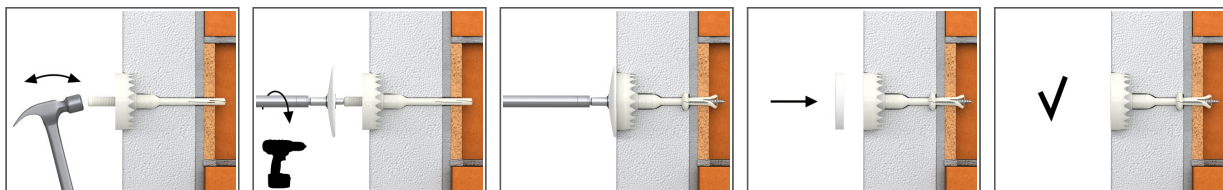

1. Drill a hole of required diameter and depth
2. Drilling depth of min 40mm in A,B,C,D materials and 80mm in Aerated Concrete Block
3. Lightly tap the plastic sleeve through the insulation material into hole with a hammer, until fixing depth is reached
4. Embedment depth of min 25mm in A,B,C,D materials and 65mm in Aerated Concrete Block
5. Tighten screw (using special TFIX-8ST-TOOL setting tool) until fixing is secure and flush with insulation material
6. Insert cap into countersunk hole in insulation

Product information

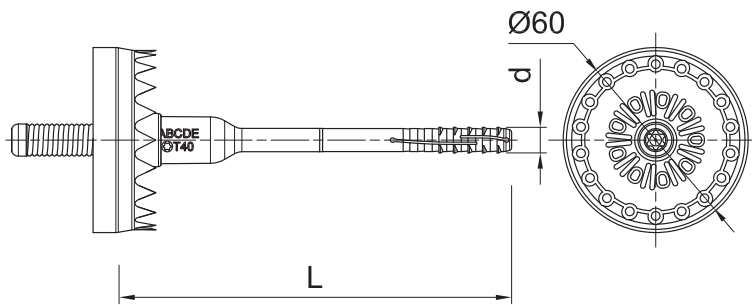

Size	Product Code	Fixing			Fixture	
		Diameter	Length	Plate diameter	Recommended thickness	
		d	L	D	t _{fix} A, B, C, D	t _{fix} E
[mm]						
Ø08	TFIX-8ST-115-ECO	8	115	60	80	40
	TFIX-8ST-135-ECO	8	135	60	100	60
	TFIX-8ST-155-ECO	8	155	60	120	80
	TFIX-8ST-175-ECO	8	175	60	140	100
	TFIX-8ST-195-ECO	8	195	60	160	120
	TFIX-8ST-215-ECO	8	215	60	180	140
	TFIX-8ST-235-ECO	8	235	60	200	160
	TFIX-8ST-255-ECO	8	255	60	220	180
	TFIX-8ST-275-ECO	8	275	60	240	200
	TFIX-8ST-295-ECO	8	295	60	260	220
	TFIX-8ST-335-ECO	8	335	60	300	260
	TFIX-8ST-355-ECO	8	355	60	320	280
	TFIX-8ST-375-ECO	8	375	60	340	300
	TFIX-8ST-395-ECO	8	395	60	360	320
	TFIX-8ST-415-ECO	8	415	60	380	340
	TFIX-8ST-435-ECO	8	435	60	400	360
TFIX-8ST-455-ECO	8	455	60	420	380	

Installation data

Substrate			A, B, C, D	E
Hole diameter in substrate	d ₀	[mm]	8	8
Min. hole depth in substrate	h ₀	[mm]	40	80
Min. installation depth	h _{nom}	[mm]	25	65
Min. substrate thickness	h _{min}	[mm]	100	100
Min. spacing	s _{min}	[mm]	100	100
Min. edge distance	c _{min}	[mm]	100	100
Fixing diameter	d	[mm]	8	8

Basic performance data

Performance data for single anchor without influence of edge distance and spacing

Substrate		Concrete C50/60	Concrete C16/20	Concrete C12/15	Solid brick Nz	Sand-lime solid brick KS	Vertically perforated clay brick HLZ	Sand-lime perforated brick KSL	Lightweight concrete solid brick V	Lightweight concrete hollow block HBL 4MPa	Lightweight concrete hollow block HBL 6MPa	Prefabricated reinforced components of lightweight aggregate concrete 4MPa	Prefabricated reinforced components of lightweight aggregate concrete 6MPa	Autoclaved aerated concrete AAC 4MPa	Autoclaved aerated concrete AAC 6MPa	
		Effective embedment depth h _{ef}	[mm]	25	25	25	25	25	25	25	25	25	25	25	65	65
MEAN ULTIMATE LOAD N _{Ru,m}																
TFIX-8ST-ECO	[kN]	1.74	2.03	1.64	1.68	1.32	0.94	1.15	0.64	0.48	0.71	0.66	0.99	1.08	1.61	

Basic performance data

Substrate	CHARACTERISTIC LOAD N_{Rk}															
	[kN]	Concrete C50/60	Concrete C16/20	Concrete C12/15	Solid brick Mz	Sand-lime solid brick KS	Vertically perforated clay brick HLZ	Sand-lime perforated brick KSL	Lightweight concrete solid brick V	Lightweight concrete hollow block HBL 4MPa	Lightweight concrete hollow block HBL 6MPa	Prefabricated reinforced components of lightweight aggregate concrete 4MPa	Prefabricated reinforced components of lightweight aggregate concrete 6MPa	Autoclaved aerated concrete AAC 4MPa	Autoclaved aerated concrete AAC 6MPa	
TFIX-8ST-ECO	[kN]	1.20	1.50	1.20	1.20	0.90	0.75	0.90	0.50	0.40	0.60	0.40	0.60	0.90	1.20	
DESIGN LOAD N_{Rd}																
TFIX-8ST-ECO	[kN]	0.60	0.75	0.60	0.60	0.45	0.38	0.45	0.25	0.20	0.30	0.20	0.30	0.45	0.60	
RECOMMENDED LOAD N_{rec}																
TFIX-8ST-ECO	[kN]	0.43	0.54	0.43	0.43	0.32	0.27	0.32	0.18	0.14	0.21	0.14	0.21	0.32	0.43	

Fixing type		TFIX-8ST-ECO
Plate resistance	[kN]	2.04
Plate stiffness	[kN/mm]	0.6
Point thermal transmittance	[W/K]	0.002

Product commercial data

Size	Product Code	Fixing			Quantity [pcs]			Weight [kg]			Bar Codes
		Diameter [mm]	Length [mm]	Plate diameter [mm]	Box	Outer	Pallet	Box	Outer	Pallet	
Ø8	TFIX-8ST-115-ECO	8	115	60	100	100	4800	4.0	4.0	222.0	5906675086491
	TFIX-8ST-135-ECO	8	135	60	100	100	4000	4.5	4.5	208.8	5906675089294
	TFIX-8ST-155-ECO	8	155	60	100	100	3200	5.0	5.0	189.0	5906675089300
	TFIX-8ST-175-ECO	8	175	60	100	100	3200	5.1	5.1	192.0	5906675089317
	TFIX-8ST-195-ECO	8	195	60	100	100	3200	5.4	5.4	201.8	5906675089324
	TFIX-8ST-215-ECO	8	215	60	100	100	3200	5.7	5.7	212.9	5906675089331
	TFIX-8ST-235-ECO	8	235	60	100	100	3200	6.1	6.1	225.2	5906675089348
	TFIX-8ST-255-ECO	8	255	60	100	100	3200	6.2	6.2	229.0	5906675089355
	TFIX-8ST-275-ECO	8	275	60	100	100	3200	6.6	6.6	240.0	5906675089362
	TFIX-8ST-295-ECO	8	295	60	100	100	3200	7.0	7.0	254.0	5906675089379
	TFIX-8ST-335-ECO	8	335	60	100	100	2400	7.8	7.8	215.9	5906675089386
	TFIX-8ST-355-ECO	8	355	60	100	100	2400	8.4	8.4	230.7	5906675118758
	TFIX-8ST-375-ECO	8	375	60	50	50	1200	4.7	4.7	141.6	5906675118765
	TFIX-8ST-395-ECO	8	395	60	50	50	1200	4.9	4.9	146.7	5906675118772
	TFIX-8ST-415-ECO	8	415	60	50	50	1200	4.7	4.7	141.8	5906675118789
	TFIX-8ST-435-ECO	8	435	60	50	50	1200	5.2	5.2	155.4	5906675118802
TFIX-8ST-455-ECO	8	455	60	50	50	1200	5.0	5.0	150.2	5906675335155	